

NW NE
3
SW SE

GLACIAL BLUE HILLS
RECREATION AREA

Town Of Barton
City Of West Bend

11190330120
4.24AC
OL 1

11190330108
0.27AC

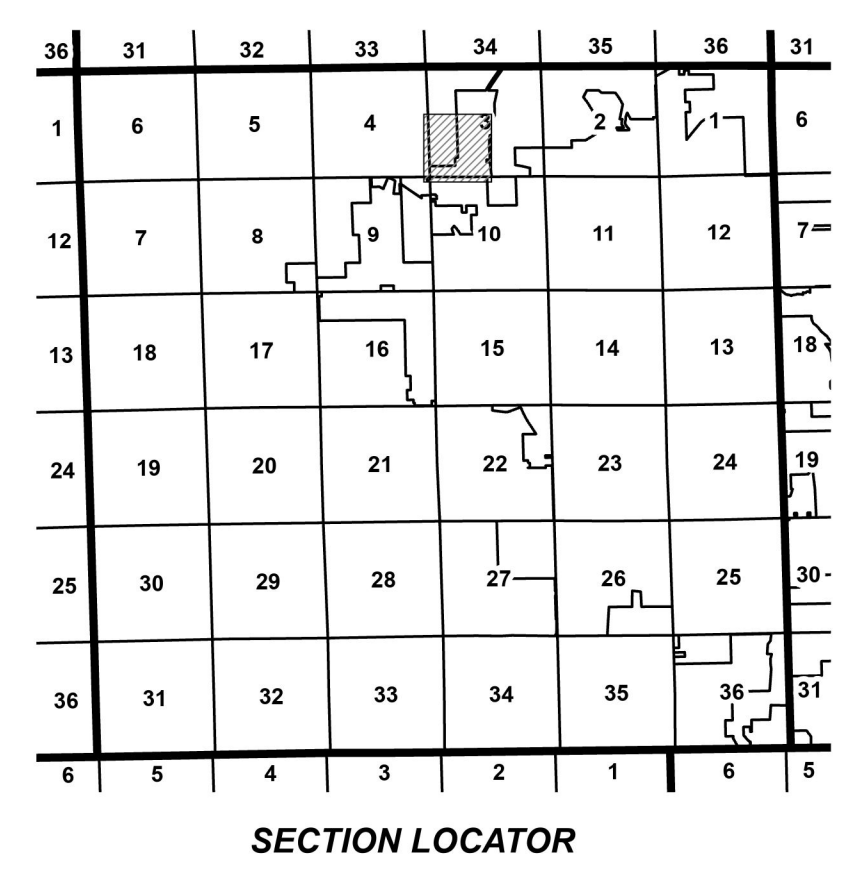
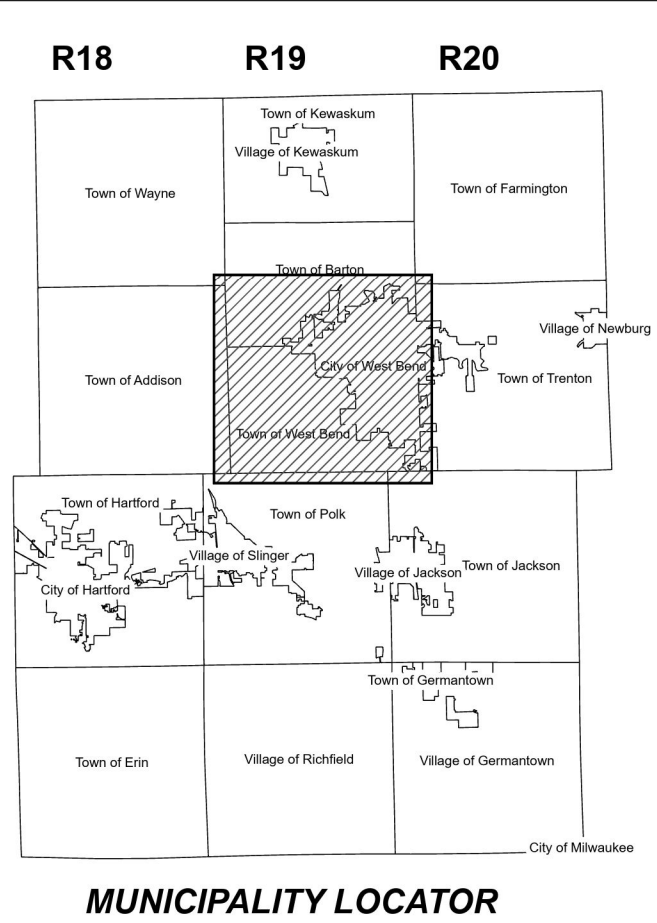

City of West Bend (291)
Town of Barton (T2)
Washington County, Wisconsin

Horizontal Datum is based on the Wisconsin State Plane Coordinate System, South Zone. North American Datum of 1983

This information is issued subject to errors and omissions and is not Certified by Washington County, WI

Prepared by the Washington County Geographic Information Systems (GIS) Department

Parcels current as of January 1, 2024
Map Produced February 15, 2024

Phone: 1-262-335-4370
https://www.washcocwisconsin.gov/departments/geographic_information_systems

- MONUMENT
- ▭ PARCEL LINE
- ▭ RECORDED PLAT
- ▭ INCORPORATION BOUNDARY
- ⋯ MEANDER LINE
- ⋯ RIGHT OF WAY
- ⋯ SECTION/QUARTER SECTION LINE
- ⋯ SURFACE WATER

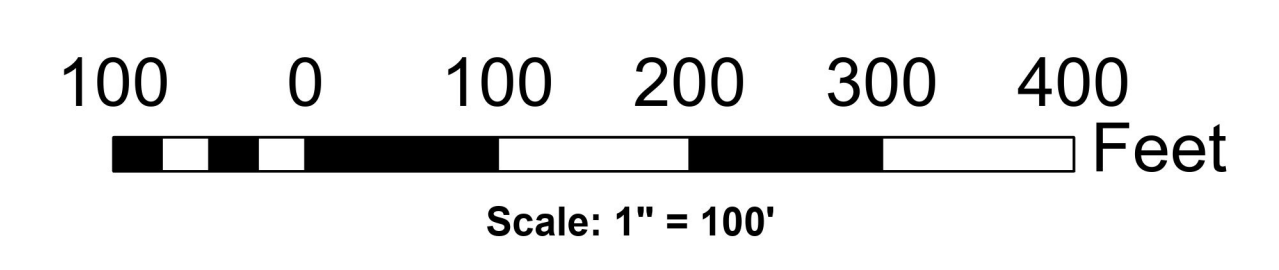
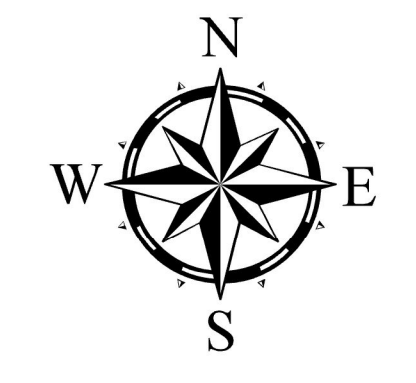

SOUTHWEST QUARTER, SECTION 3