

WASHINGTON COUNTY HIGHWAY REGISTER

FOREWORD

The County Highway Register is an attempt to search out, correlate, and record all known information concerning the laying out of all roads in the county. It is required under the provisions of Section 83.01(7) (G) as amended by Chapter 163, Acts of the Legislature of 1957. This act specifically excludes incorporated places from the study, hence there will be found no information concerning city and village streets.

In looking for information, the following records have been searched:

1. Proceedings of the Board of County Commissioners, found in the office of the County Clerk.
2. The office of Secretary of State and the Congressional Records, both through the cooperation of the State Highway Commission.
3. The office of the County Court. Here no records apparently were ever filed as none could be found.
4. The office of each Town Clerk in the county. These offices were the best source of information.

Early records were often very sketchy, in some extreme cases merely locating the beginning and the end of a piece of road, occasionally several miles apart with no description of the route between them. Other descriptions involved the use of names of pioneer property owners, buildings, or trees now impossible to locate. Other roads were described by distances from topographical features, such as hills, streams, marshes or lakes, which were too general for anything more than an approximate location. In many cases the road was laid out on a section or quarter section line "or as near thereto as the country may permit." Usually no record was kept of these minor variations. Even where the road was laid on a specific line, the early construction men found natural obstructions too difficult to permit strict adherence to the record. In case of doubt effort has been made to abide by the best information available, at the same time considering the present location of the road. All descriptions which approximate a presently located highway have been indicated on the Register of Index Sheet, although only existing public roads have been shown on the map.

Often a piece of road was laid out more than once, either by the same or a different authority, and perhaps of different widths of right of way. In coloring the map and on the Index Sheet, the latest record has been used. It is felt that this is the legal one, as the Town Boards have the right to lay, alter and abandon any road at any time.



The Register does not concern itself with the Town Road System, the County Road System, nor the State Trunk System as such. The two latter are of comparatively recent origin and have been largely superimposed on the basic system of older roads. A few State or County Trunks have put on virgin locations. These are shown on the Register. Modern construction requires the purchase of wide right of way. Purchases vary in width from farm to farm, or indeed along different parts of the same farm. To include such a mass of detail in this report would be impossible. Where purchase of land were extensive, the road has been shown in brown and the reader referred to the project number. Right of way sketches are available under the project number in the office of the Register of Deeds, the State Highway Commission at Madison and Waukesha, and at the office of the County Highway Commissioner. In addition to the above variation, the stated width may vary in short sections due to purchases of very small bits of property here and there. Where available these have been noted in the Register Sheet. Most of these small purchases were not recorded at all in earlier years, particularly prior to about 1926. The study will therefore contain comparatively few references to the Grantor-Grantee Index.

Town records of laying out roads have been reproduced and are included. Many pages of Town Records concerning roads have not been reproduced, in the interest of brevity. Preceding in lay a road often include pages for Petition, Notice of Hearing, Notice of Posting or adjournment, and award of damages. These may be necessary legal steps, but would add nothing to the clarity of the Register. Any interested person will find them in the same volume and on adjacent pages to the actual laying.

Information from the offices of County Clerk and Register of Deeds has not been reproduced, as it is readily available in the offices where kept

STATE HIGHWAY COMM. OF WISCONSIN TOWN PLAT RECORD

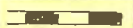
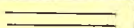
Town - FARMINGTON County - WASHINGTON

Date of Last Corr.	State Trunks	County Trunks	Local Roads	Symbols
				
1-1-56	14.31	16.84	53.52	Sch. 
1-1-57	14.31	16.84	53.52	Cem. 
1-1-58	14.31	16.84	53.52	
1-1-59	14.33	16.96	55.28	

55.28 - 0.43 = 54.85

Certified as Correct By Town Chairman: _____

WIDTHS OF RIGHT OF WAY
 GREEN - 4 RODS BY ORDER
 BLUE - 4 RODS BY STATUTE, SEC. 80.08
 RED - 3 RODS BY ORDER
 YELLOW - MISCEL. SEE INDEX SHEET
 BROWN - WIDTH VARIES

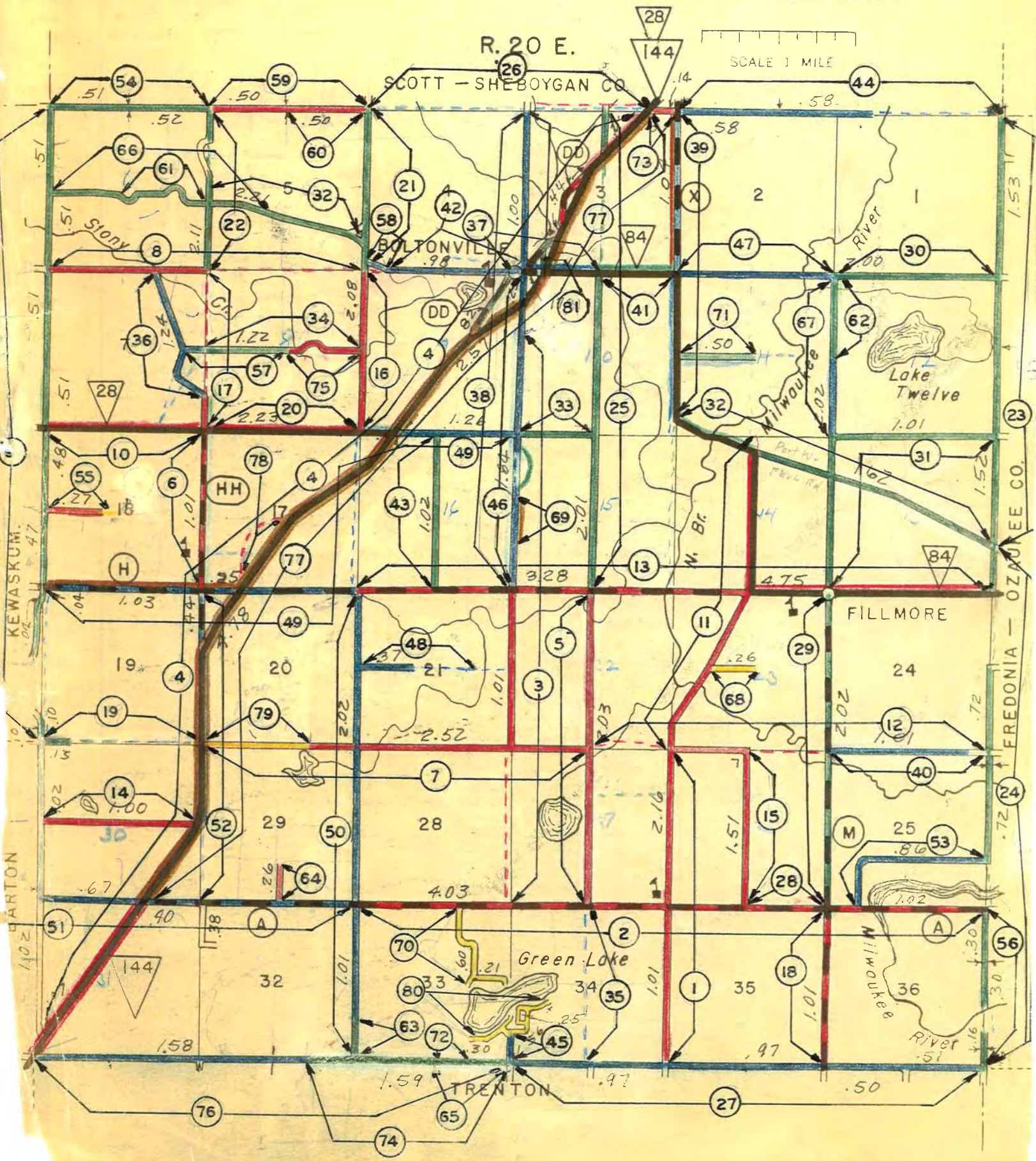

Map Index No.	Instrument	Name of Highway	Sections of Land Effected	Grantor-Grantee Index		Width	
				Vol.	Page	Feet	Authority
1	Order		26,27,34,35			49½	Order
2	Order	C.T.H. "A"	28,33,27,34, 26,35,25,36			49½	Order
3	Order		27,28,21,22, 16,15,10,9			49½	Order
4	Order	S.T.H. "144" and C.T.H. "DD" also parts of C.T.H. "H" and "HH"	31,30,29,19, 20,17,16,9,3			49½ 66	Order-1847 Order-1858
5	Order		22,27,34			49½	Order
6	Order	C.T.H. "HH"	6			49½	Order
7	Order		20,29,21,28 22,27			49½	Order
8	Order		6,7,5,8,4,9			49½	Order
9	Order		Range Line 6,7,18,19			66	Order in 1849 and by Statute in 1860
10	Order	S.T.H. "28" Only a portion of above is	7,18 4 rods.	121 Vision Cor. in NW¼ NW¼ Sec.18	230	49½ 66	Order 1847 Statute 1859
11	Order	Mill Road	14,22,23			49½	Order
12	Order		24,25,23,26 22,27			49½	Order
13	Order	S.T.H. "84" and C.T.H. "H"	13,24,14,23 15,22,16,21			49½	Order
14	Order		30			49½	Order
15	Order		26			49½	Order
16	Order		8,9 ✓			49½	Order
17	Order		7,8 ✓			49½	Order
18	Order	C.T.H. "M"	35,36			49½	Order
19	Order		19,30			49½ 66	Order Order
20	Order	S.T.H. "28"	8,17 ✓			49½	Order
21	Order		4,5			66	Order
22	Order		5,6			66	Order
23	Order		1,12,13			66	Order
24	Order		13,24,25,36			66	Order
25	Order		3,10,15 ✓			66	Order
26	Order		3,4 ✓			66	Statute
27	Order		34,35,36			66	Statute-1850
28	Order		26,35			66	Statute

See No. 40

Map Index No.	Instrument	Name of Highway	Sections of Land Effected	Grantor-Grantee Index		Width	
				Vol.	Page	Feet	Authority
29	Order	C.T.H. "M"	23,24,25,26			66	Order
30	Order		1,12			66	Order
31	Order		12,13,14			66	Order
32	Order	S.T.H. "84" in part	5,11,13,14			66	Order
	Order					66	Statute
33	Order		10,15			66	Order
34	Order		8 ✓			66	Order
35	Order		34			66	Statute
36	Order		7			66	Statute
37	Order		3,4,10,9			66	Statute 1870
						66	Statute 1872
38	Order		15,16,9,10 3,4			66	Statute
39	Order	S.T.H. "84" and C.T.H. "X"	2,3,10,11			66	Statute
40	Order		24,25			66	Statute
41	Order		3,10			66	Order 1855
						66	Statute 1854
42	Order		4,9			66	Statute
43	Order		16			66	Order
44	Order		1,2			66	Statute
45	Order		33,34			66	Statute
46	Order		9,10,15,16			66	Statute 1857
						66	Order 1862
47	Order		2,11			66	Statute
48	Order		21			66	Statute 1857
							Statute 1860
49	Order		9,16,17,19,20 18			66	Statute
50	Order		20,21,28,29 32,33			66	Statute
51	Order		29,30,31,32			66	Statute
52	Order		19,20,29,30			66	Statute
53	Order		25			66	Statute
54	Order		6			66	Order
55	Order		18			16 $\frac{1}{2}$ 49 $\frac{1}{2}$	Order 1859 Order 1935
56	Order		36			66	Order
57	Order		7,8 ✓			66	Order
58	Order		4			66	Statute

Map Index No.	Instrument	Name of Highway	Sections of Land Effected	Grantor-Grantee Index		Width	
				Vol.	Page	Feet	Authority
59	Order		5			49½	Order
60	Order		5			49½	Order
61	Order		6			66	Statute 1852 Order 1868
62	Order		11,12			66	Order
63	Order		32,33			66	Order
64	Order		20			49½	Order
65	Order		33			66	Statute 1857
66	Order		5,6			66	Order
67	Order		11,12			66	Statute
68	Order		23			33	Order
69	Order		15,16			Var.	Order
70	Dedication	Green Lake Subd. No. 2	33			50	Dedication
71	Order		11			66	Order
72	Order		33			66	Statute
73	Order		3			49½	Order
74	Order		32,33			66	Order
75	Order		8			66 49½	Statute 1876 Order 1877
76	Order		31,32,33			66	Statute
32	Order		11,13,14			66	Statute= Superceded in part by later order
77	Reloc.order	S.T.H. "144"	3,9,10,16,17 19,20,29,30			Var.	State Hwy. Comm.
78	Order	Old S.T.H. "144"	17		Abandoned		Order
79	Order		20,29			33	Order
80	Dedicated	Green Lake Subd. No. 1 Cedar Park Subd.	33,34 33,34			50 40-49½	Dedication Dedication
81	Dedicated	Bolton's Ville Subdivision	3			66	Dedicated

Map Index No.	Source of Information				Page in C.H.R.	Page Shown in C.H.R.	Date Laid
	Office	Name of Record	Vol.	Page			
1	Town Clerk	Town Proceedings	1	12	1,2	Yes	1847
2	Town Clerk	Town Proceedings	1	13	2,3	Yes	1847
3	Town Clerk	Town Proceedings	1	13,14	2,3	Yes	1847
4	Town Clerk	Town Proceedings	1	14-16	3,4	Yes	1847
			1	25,7	49,50	Yes	1858
			10	26,27,28			1852
			11	118-120	115-117	Yes	1847
5	Town Clerk	Town Proceedings	1	18	6	Yes	1847
6	Town Clerk	Town Proceedings	1	20	8	Yes	1847
7	Town Clerk	Town Proceedings	1	18	7	Yes	1847
			2	212	91	Yes	1874
			11	162,3	119,120	Yes	1891
8	Town Clerk	Town Proceedings	1	21	9	Yes	1847
9	Town Clerk	Town Proceedings	1	24	10	Yes	1849
			1	297,98	60,61	Yes	1860
			1	300		Yes	1860
			1	301			
10	Town Clerk	Town Proceedings	1	27	11	Yes	1847
			1	287,8			1859
11	Town Clerk	Town Proceedings	1	27,28	11,12	Yes	1848
12	Town Clerk	Town Proceedings	1	28	12	Yes	1848
See No 40							
13	Town Clerk	Town Proceedings	1	28	12	Yes	1848
14	Town Clerk	Town Proceedings	1	29	13,14	Yes	1848
15	Town Clerk	Town Proceedings	1	29,30	13,14	Yes	1848
16	Town Clerk	Town Proceedings	1	35	15	Yes	1848
17	Town Clerk	Town Proceedings	1	38	16	Yes	1848
			1	380,381	70,71	Yes	1863
18	Town Clerk	Town Proceedings	1	38	16	Yes	1848
19	Town Clerk	Town Proceedings	1	39	17	Yes	1848
			1	94	33	Yes	1852
20	Town Clerk	Town Proceedings	1	41	18	Yes	1848
21	Town Clerk	Town Proceedings	1	50	19	Yes	1848
22	Town Clerk	Town Proceedings	11	50	19	Yes	1848
23	Town Clerk	Town Proceedings	1	56	20	Yes	1849
24	Town Clerk	Town Proceedings	1	56,57	20,21	Yes	1850
			2	162,163	89,90	Yes	1872
25	Town Clerk	Town Proceedings	1	57	21	Yes	1850
26	Town Clerk	Town Proceedings	1	58	22	Yes	1850
27	Town Clerk	Town Proceedings	1	58	22	Yes	1850
			11	115	112	Yes	1850
28	Town Clerk	Town Proceedings	1	59	23	Yes	1850

Map Index No.	Source of Information			Page in C.H.R.	Page Shown in C.H.R.	Date Laid
	Office	Name of Record	Vol.			
29	Town Clerk	Town Proceedings	1	60	24	Yes 1850
30	Town Clerk	Town Proceedings	1	60	24	Yes 1850
31	Town Clerk	Town Proceedings	1	60,61	24,25	Yes 1850
32	Town Clerk	Town Proceedings	1	71,72	26,27	Yes 1850
	Town Clerk	Town Proceedings	8	137-8	99,100	Yes 1899-1900
	County Clerk	Proceed. Co. Commr's.	A	187	-	No * 1846
33	Town Clerk	Town Proceedings	1	91	30	Yes 1852
34	Town Clerk	Town Proceedings	1	92	31	Yes 1852
			2	285		1877
35	Town Clerk	Town Proceedings	1	95	34	Yes 1852
			1	216	45	Yes 1857
36	Town Clerk	Town Proceedings	1	129	38	Yes 1853
37	Town Clerk	Town Proceedings	1	130	39	Yes 1853
			2	108	86	Yes 1870
			2	154,5	87,88	Yes 1872
38	Town Clerk	Town Proceedings	1	130	39	Yes 1853
39	Town Clerk	Town Proceedings	1	130	39	Yes 1853
40	Town Clerk	Town Proceedings	1	130	39	Yes 1853
41	Town Clerk	Town Proceedings	1	148	40	Yes 1854
			1	156	42	Yes 1855
42	Town Clerk	Town Proceedings	1	148	40	Yes
			1	288-9	56,57	Yes 1859
43	Town Clerk	Town Proceedings	1	155	41,42	Yes 1855
				156		
44	Town Clerk	Town Proceedings	1	195-6	43, 43A	Yes 1856
			11	109	107	Yes 1856
45	Town Clerk	Town Proceedings	1	230	46	Yes 1857
			11	162	119	Yes 1857
46	Town Clerk	Town Proceedings	1	230	46	Yes 1857
			1	352,3	67,68	Yes 1862
47	Town Clerk	Town Proceedings	1	230	46	Yes 1857
48	Town Clerk	Town Proceedings	1	231	59,60	Yes 1857
			1	296,297		Yes 1860
49	Town Clerk	Town Proceedings	1	264,5	51	Yes 1846
			1	393	616	Yes 1861
50	Town Clerk	Town Proceedings	1	264,5	51	Yes 1846
51	Town Clerk	Town Proceedings	1	264,5	51	Yes 1846
52	Town Clerk	Town Proceedings	1	264,5	51	Yes 1846
			1	118		Yes 1852
53	Town Clerk	Town Proceedings	1	266	53	Yes 1859
54	Town Clerk	Town Proceedings	1	267	54	Yes 1859
55	Town Clerk	Town Proceedings	1	295,6	58,59	Yes 1859
			11	167	121	Yes 1935

* The Board of County Commissioners Volume A pages have been scanned and can be found on the highway registry books webpage under the listed township.

Map Index No.	Source of Information				Page in C.U.P.	Page Shown in C.U.P.	Date Paid
	Office	Name of Record	Vol.	Page			
56	Town Clerk	Town Proceedings	1	332	65	Yes	1862
57	Town Clerk	Town Proceedings	1	379,380	69,70	Yes	1863
58	Town Clerk	Town Proceedings	1	407	72	Yes	1864
59	Town Clerk	Town Proceedings	1	437	74	Yes	1866
60	Town Clerk	Town Proceedings	11	109-111 Inc.	107- 109 Incl.	Yes	1893
61	Town Clerk	Town Proceedings	2	15	15	Yes	1867
			2	62,63	78,79,80	Yes	1868
62	Town Clerk	Town Proceedings	2	82,83	81,82	Yes	1869
63	Town Clerk	Town Proceedings	2	344,345	97,98	Yes	1879
64	Town Clerk	Town Proceedings	9	227,228	101,102	Yes	1931
65	Town Clerk	Town Proceedings	11	114	111	Yes	1857
66	Town Clerk	Town Proceedings	1	90	29	Yes	1852
67	Town Clerk	Town Proceedings	1	331	64	Yes	1861
68	Town Clerk	Town Proceedings	1	155	41	Yes	1854
69	Town Clerk	Town Proceedings	11	146	118	Yes	1884
70	Town Clerk	Town Proceedings	10	106	106	Yes	1949
71	Town Clerk	Town Proceedings	1	204	44	Yes	1856
72	Town Clerk	Town Proceedings	11	112	110	Yes	1846
			1	409	73	Yes	1864
73	Town Clerk	Town Proceedings	2	106-7	84,85	Yes	1870
74	Town Clerk	Town Proceedings	2	266-7	92,93	Yes	1877
			11	116-17	113-114	Yes	1877
75	Town Clerk	Town Proceedings	2	105,6	83,84	Yes	1870
			2	285,6,7,	94,95	Yes	1877
76	Town Clerk	Town Proceedings	11	115,116	112,113	Yes	1892
77	St.Hwy. Comm. County Hwy. Comm.	Plan FAP	Right of Way Plats			No	
78	Town Clerk	Town Proceedings	10	26-28	103 to 105	Yes	1943
79	Town Clerk	Town Proceedings	2	60,61	76,77	Yes	1868
80	County Clerk	Plat Book	8	14	-	No	1949
81	County Clerk	Plat Book	1	21	-	No	1855