

1915

BARTON

IN BARTON TOWNSHIP

Scale 400 feet to one inch.

1915

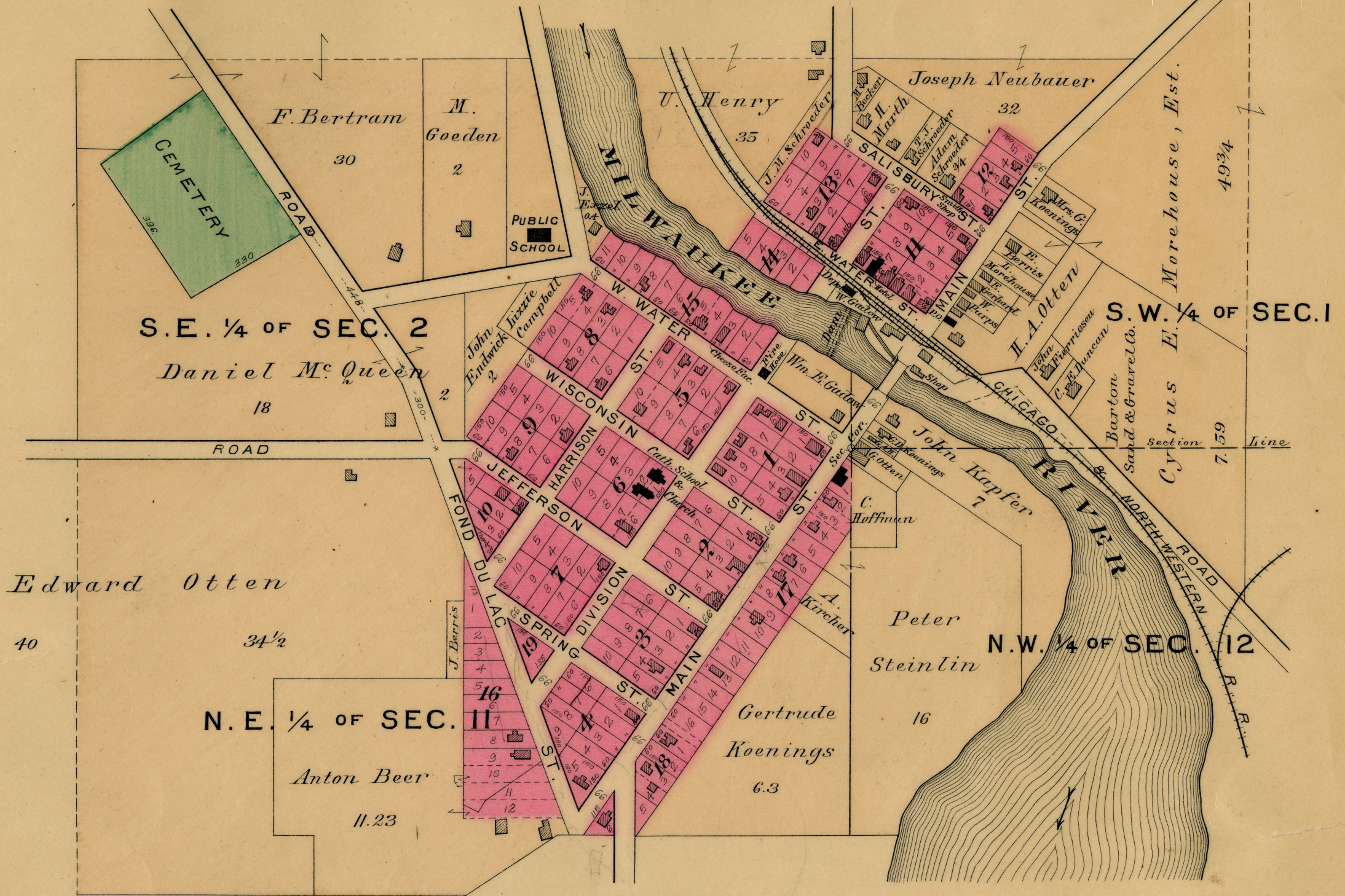

S.E. 1/4 OF SEC. 2

Daniel McQueen

ROAD

Edward Otten

40

N.E. 1/4 OF SEC. 11

Anton Beer

11.23

MILWAUKEE RIVER

WATER ST.

WISCONSIN ST.

HARRISON ST.

JEFFERSON ST.

FOND DU LAC ST.

SPRING DIVISION ST.

MAIN ST.

Joseph Neubauer

32

SALISBURY ST.

WATER ST.

MAIN ST.

CHICAGO RIVER

ST. JOHN'S CHURCH

ST. MARY'S CHURCH

ST. ANNE'S CHURCH

ST. MICHAEL'S CHURCH

ST. PETER'S CHURCH

ST. PAUL'S CHURCH

ST. JOSEPH'S CHURCH

ST. MARGARET'S CHURCH

ST. ELIZABETH'S CHURCH

ST. ANTHONY'S CHURCH

ST. FRANCIS' CHURCH

ST. JOSEPH'S CHURCH

ST. MARY'S CHURCH

ST. ANNE'S CHURCH

ST. MICHAEL'S CHURCH

ST. PETER'S CHURCH

ST. PAUL'S CHURCH

ST. JOSEPH'S CHURCH

ST. MARGARET'S CHURCH

ST. ELIZABETH'S CHURCH

S.W. 1/4 OF SEC. 1

John Kapfer

7

CHICAGO RIVER

ST. JOHN'S CHURCH

ST. MARY'S CHURCH

ST. ANNE'S CHURCH

ST. MICHAEL'S CHURCH

ST. PETER'S CHURCH

ST. PAUL'S CHURCH

ST. JOSEPH'S CHURCH

ST. MARGARET'S CHURCH

ST. ELIZABETH'S CHURCH

ST. ANTHONY'S CHURCH

ST. FRANCIS' CHURCH

ST. JOSEPH'S CHURCH

ST. MARGARET'S CHURCH

ST. ELIZABETH'S CHURCH

ST. ANTHONY'S CHURCH

N.W. 1/4 OF SEC. 12

Peter Steintin

16

Gertrude Koenings

6.3

Morehouse, Est.

49 3/4

7.59

Barton Sand & Gravel Co.

Section

Line

John Kapfer

7

CHICAGO RIVER

ST. JOHN'S CHURCH

ST. MARY'S CHURCH

ST. ANNE'S CHURCH

ST. MICHAEL'S CHURCH

ST. PETER'S CHURCH

ST. PAUL'S CHURCH

ST. JOSEPH'S CHURCH

ST. MARGARET'S CHURCH

ST. ELIZABETH'S CHURCH

ST. ANTHONY'S CHURCH