

1915

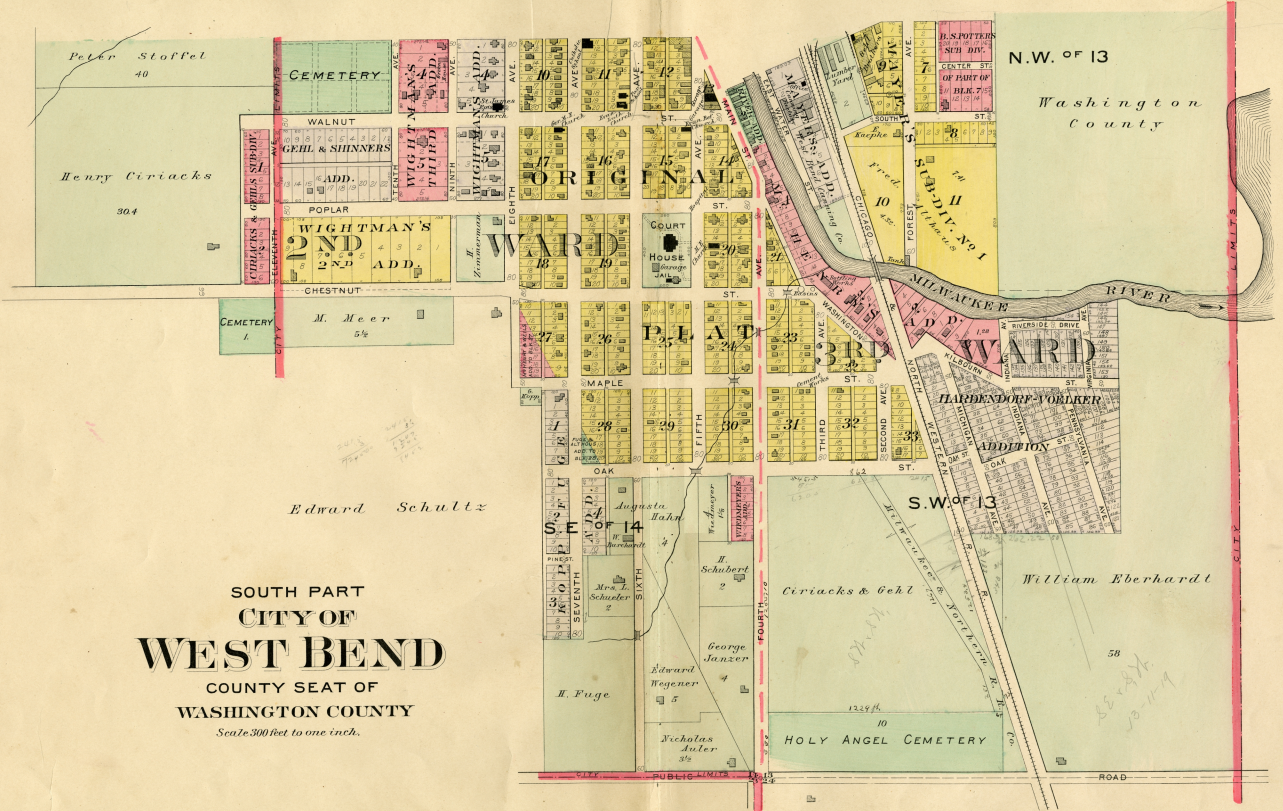

SOUTH PART
CITY OF
WEST BEND

COUNTY SEAT OF
WASHINGTON COUNTY

Scale 300 feet to one inch.

Edward Schultz

N.W. OF 13

Washington
County

ORIGINAL
WARD

PLAT
WARD

WARD

HARDENDORF-VORLEKER
ADDITION

S.W. OF 13

Ciriacks & Gehl

William Eberhardt

HOLY ANGEL CEMETERY

ROAD